

## FEATURES

- > RF efficient design offers high power handling in a small package
- > Can be mounted in any position, any axis
- > Meets or exceeds standards set in MIL-R-83725

## PRODUCT SPECIFICATIONS

Contact & Relay Ratings	Units	GJ44P
<b>Contact Form</b>		P
<b>Contact Arrangement</b>		SPST-latching
<b>Voltage, Test Max., Contacts &amp; to Base (30 µA Leakage Max., dc or 60Hz)</b>	kV Peak	6
<b>Voltage, Operating Max., Contacts &amp; to Base (30 µA Leakage Max.)</b>		
dc or 60 Hz	kV Peak	5
2.5 MHz	kV Peak	3.6
16 MHz	kV Peak	3.2
32 MHz	kV Peak	2.5
<b>Current, Continuous Carry Max</b>		
dc or 60 Hz	Amps	12
2.5 MHz	Amps	10
16 MHz	Amps	6
32 MHz	Amps	5
<b>Coil Hi-Pot (V RMS, 60 Hz)</b>	V	500
<b>Capacitance</b>		
Across Open Contacts	pF	1.6
Contacts to Ground	pF	1.6
<b>Resistance, Contact Max @ 1A, 28 Vdc</b>	ohms	0.012
<b>Latch Time</b>	ms	4
<b>Reset Time</b>	ms	4
<b>Life, Mechanical</b>	cycles	1 million
<b>Weight, Nominal</b>	g (oz)	28 (1)
<b>Vibration, Operating, Sine (95-2000 Hz Peak)</b>	Gs	30
<b>Shock, Operating, 1/2 Sine 11ms (Peak)</b>	Gs	50
<b>Temperature Ambient Operating</b>	°C	-55 to +125

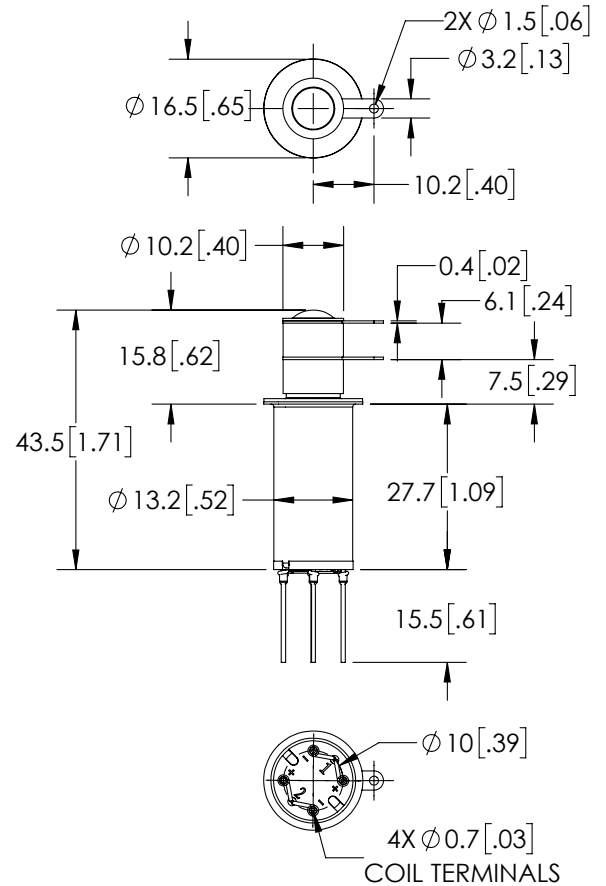

## PART NUMBER SYSTEM

GJ44P	3	3	4
<b>Coil Voltage</b>	3 = 26.5 Vdc, Bus Wire		
<b>High Voltage Connections</b>		3 = Solder connection	
<b>Mounting</b>			4 = Std Flange

## COIL RATINGS

Nominal, Volts dc	26.5
Latch, Volts dc Max	16
Reset, Volts dc	1-10
Coil Resistance (Ohms $\pm 10\%$ )	80